

ORDER TODAY

mail-in or order online

REASONS TO PURCHASE

savings & convenience



The easiest and most convenient way to get your dining plan is to order online. Debit, Master Card and Visa are accepted. For mail-in orders, complete the form below and mail to the Chartwells office. Students will need to visit the office to activate their plans once purchased.

CHARTWELLS DINING SERVICES

PHONE | (519) 748-5039

IN PERSON | Chartwells Office at each campus

ONLINE | www.dineoncampus.ca/conestoga

E-MAIL | Jennifer.Bruder@compass-canada.com

First Name: _____

Last Name: _____

Phone Number: _____

Email: _____

- Annual Swipe & Save Plan - \$1990 Dining Dollars (Tax Exempt)
- Semester Swipe & Save Plan - \$995 Dining Dollars (Tax Exempt)
- Swipe & Save Reloadable Card. Min. \$100 dollars - (Taxable plan)

Value: _____

*Make cheques payable to: Chartwells



With your time spent getting to and from classes, studying, socializing and meeting academic obligations, let us **SAVE** you **TIME**, **STRESS** and **MONEY** with a simple SWIPE that makes dining on campus **EASY** and more **AFFORDABLE!**

It is quick and easy to add funds to your Swipe & Save Card, than you swipe just like a debit card but without the fees or long wait times for debit processing.

You can purchase a plan any time during the year, however, the earlier you choose one the sooner you save.

MEMBERSHIP TO SAVINGS

Purchase with Swipe & Save Dollars and **SAVE 5%** on food and beverage purchases at the Market Café on non-branded locations. Plus watch for **EXCLUSIVE SAVINGS PROMOTIONS** for Swipe & Save plan members only.



Dining Plans

2014 | 2015

COMMUTER STUDENTS

Conestoga College



13% TAX SAVINGS

ON SELECT PLANS



DINING PLANS

dining made easy

DINE AT ALL FOUR CAMPUSES WITH YOUR PLAN

value, variety, convenience

SWIPE & SAVE PLANS

Swipe & Save plans use a declining balance technology similar to a debit card but without the fees. Funds are loaded onto a Swipe & Save card and you simply swipe to purchase your meals and snacks at the Market Café. Minimum load value is \$100.



ANNUAL SWIPE & SAVE PLAN

\$1,990 Dining Dollars (Tax Exempt- Save 13%)

Dine at the Market Café and receive a 5% discount on non-branded purchases every time you use the card. This plan provides great value and does expire at the end of April 2015, so use up all of your Dining Dollars.



SEMESTER SWIPE & SAVE PLAN

\$995 Dining Dollars (Tax Exempt- Save 13%)

Dine at the Market Café and receive a 5% discount on non-branded purchases every time you use the card. This plan provides great value and does expires at the end of each current semester, so use up all of your Dining Dollars.



SWIPE & SAVE RELOADABLE CARD

Load the Swipe & Save Card (minimum \$100) and receive a 5% discount on non-branded purchases every time you use the card at the Market Café. These dollars don't expire but a hold will be placed on the card on April 30, 2015 to protect your balance while on summer term. Simply reactive your card when you come back to campus at the Chartwells Office, our staff will be ready to help you.

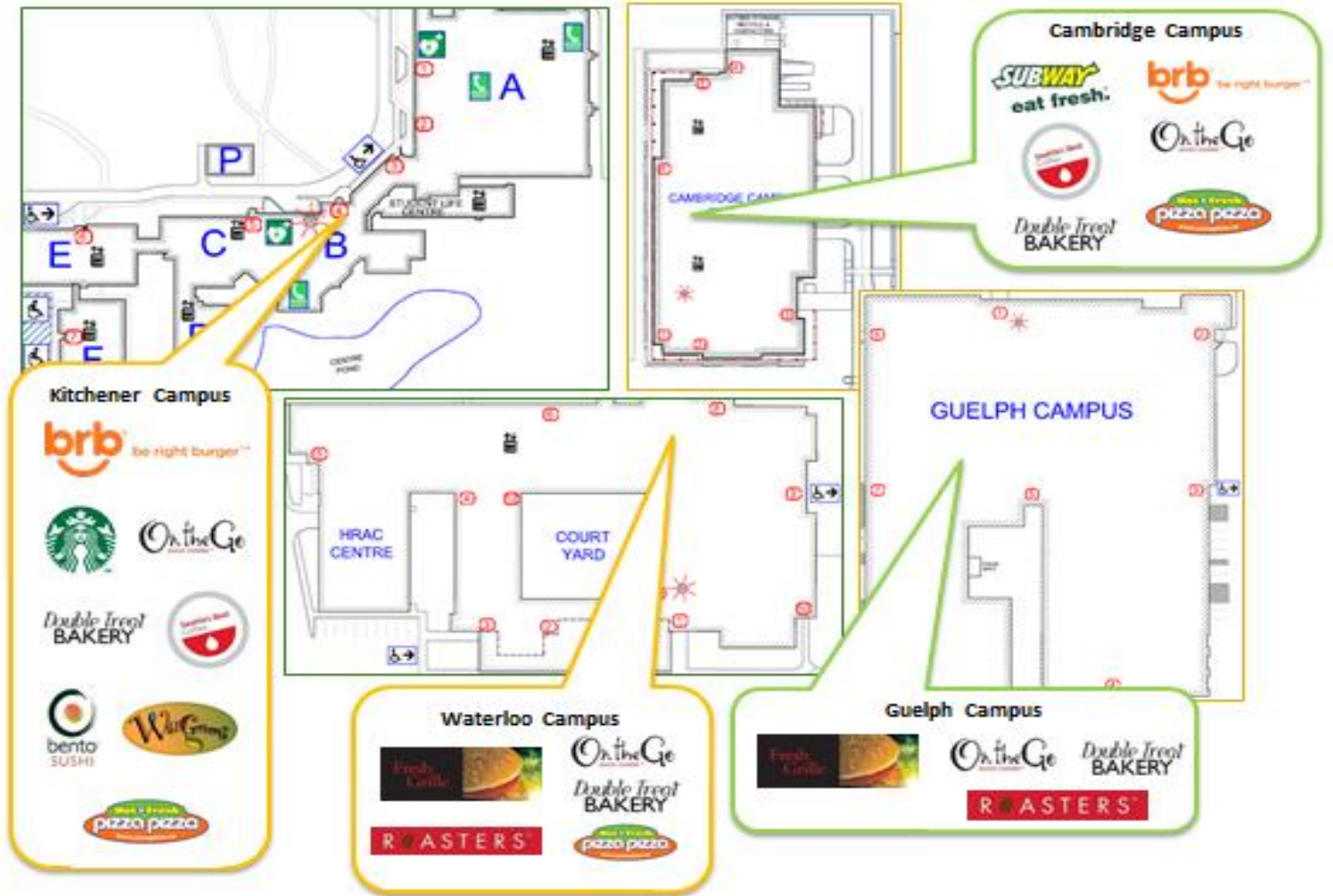

THE *swipe & save* ADVANTAGE

SAVE 5% on non-branded purchases at the Market Café.

Watch for **exclusive savings promotions** for Swipe & Save plan members